

DESIGN FEATURES RELATING TO CONSTRUCTION OR TO REGULATION AND CONTROL OF TRAFFIC MAY BE SUBJECT TO CHANGE AS DEEMED NECESSARY BY THE DEPARTMENT

| REVISED                                      | FHWA REGION | STATE | FEDERAL AID PROJECT | ROUTE | PROJECT                       | SHEET NO. |
|--|-------------|-------|---------------------|-------|-------------------------------|-----------|
| 01-27-97<br>02-18-97<br>02-25-97<br>05-13-97 | 3           | VA    |                     | 172   | 0172-147-104, C-501<br>RW-201 | 3         |

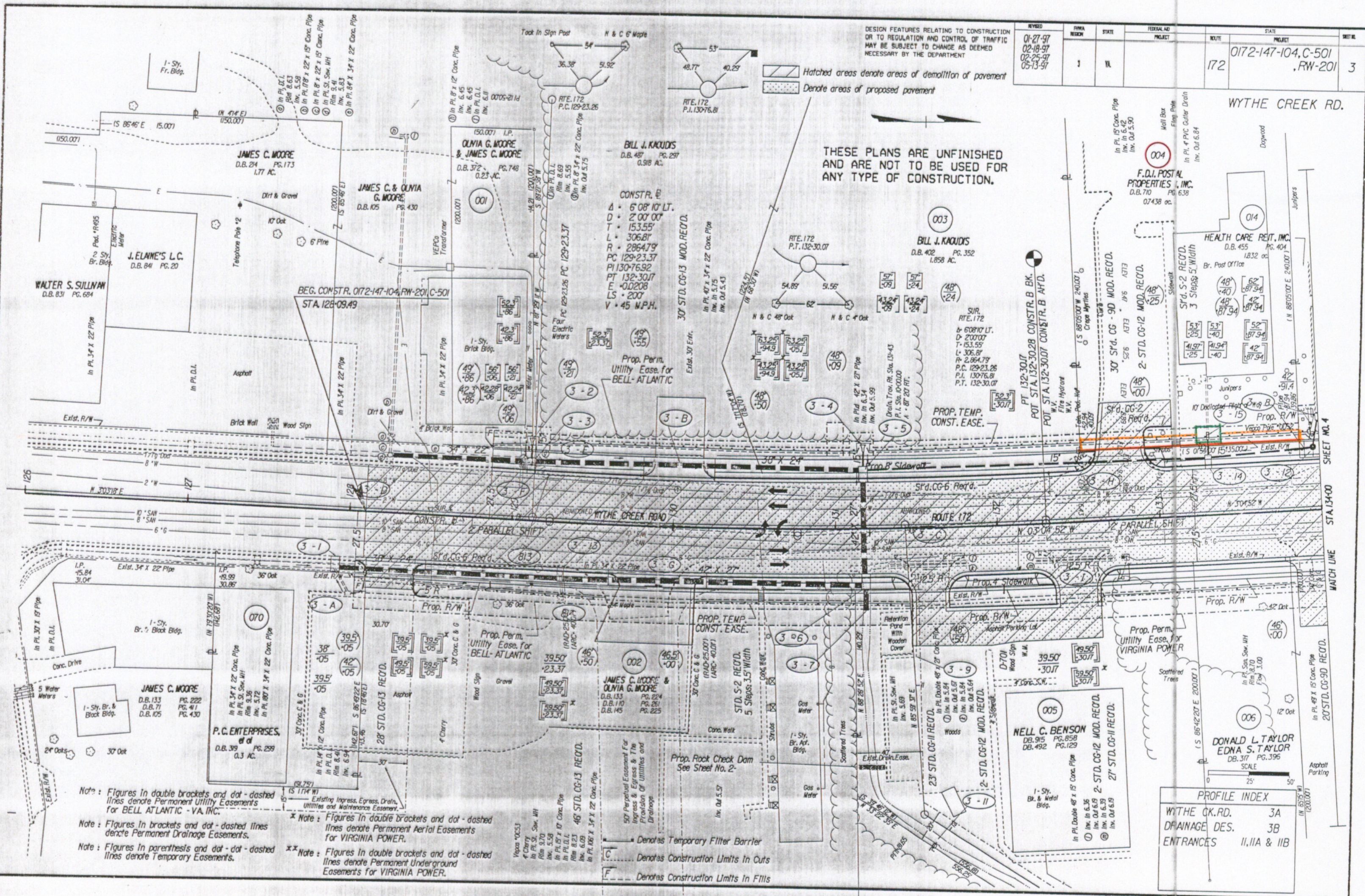

THESE PLANS ARE UNFINISHED AND ARE NOT TO BE USED FOR ANY TYPE OF CONSTRUCTION.

Hatched areas denote areas of demolition of pavement  
 Denote areas of proposed pavement

WYTHE CREEK RD.

PROFILE INDEX

|               |               |
|---------------|---------------|
| WYTHE CR. RD. | 3A            |
| DRAINAGE DES. | 3B            |
| ENTRANCES     | II, IIA & IIB |

Note: Figures in double brackets and dot-dashed lines denote Permanent Utility Easements for BELL ATLANTIC - VA, INC.  
 Note: Figures in brackets and dot-dashed lines denote Permanent Drainage Easements.  
 Note: Figures in parentheses and dot-dot-dashed lines denote Temporary Easements.  
 Note: Figures in double brackets and dot-dashed lines denote Permanent Aerial Easements for VIRGINIA POWER.  
 Note: Figures in double brackets and dot-dashed lines denote Permanent Underground Easements for VIRGINIA POWER.

SUPERVISED BY: J.C. CUTRIGHT  
 DESIGNED BY: S.W. WILKINS  
 CADD OPERATOR/NAME: [unclear]  
 REVISED BY: [unclear]

SHEET NO. 4

STA 134+00

MATCH LINE