

REVISED	FHWA REGION	STATE	FEDERAL AID PROJECT	ROUTE	STATE PROJECT	SHEET NO.
10-07-96 09-03-97	3	VA.		630	0630-099-165, M-502	4

DESIGN FEATURES RELATING TO CONSTRUCTION OR TO REGULATION AND CONTROL OF TRAFFIC MAY BE SUBJECT TO CHANGE AS DEEMED NECESSARY BY THE DEPARTMENT

SUFFOLK DISTRICT DESIGN UNIT

SUPERVISED BY: E. N. HOLLOWELL
 DESIGNED BY: D. B. WINSLOW
 CAD OPERATOR: [Name]
 REVISED BY:

PLAN NO.	DATE	BY
09/22/97 140258		
NOTE BOOK		
NO.		

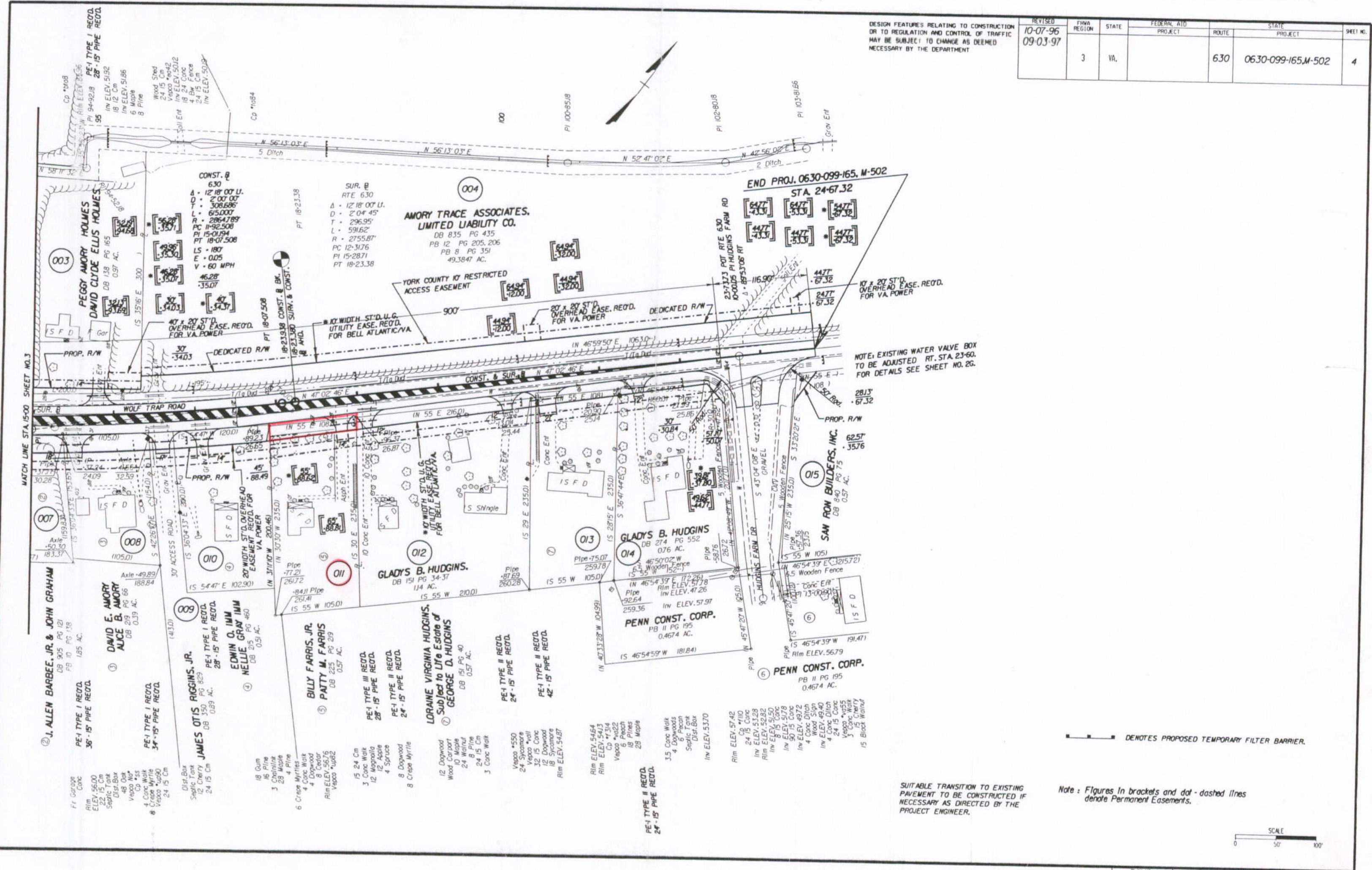

NOTE: EXISTING WATER VALVE BOX TO BE ADJUSTED RT. STA. 23+60. FOR DETAILS SEE SHEET NO. 26.

— DENOTES PROPOSED TEMPORARY FILTER BARRIER.

SUITABLE TRANSITION TO EXISTING PAVEMENT TO BE CONSTRUCTED IF NECESSARY AS DIRECTED BY THE PROJECT ENGINEER.

Note: Figures In brackets and dot-dashed lines denote Permanent Easements.

